

Wem Rural Parish Annual Meeting 2012

www.wemrural.org.uk

www.facebook.com/wemruralcommunity



Welcome

- Minutes from 2011
- Parish Council Report
- Parish Plan
- Wem Community Jubilee Celebrations
- Severn Trent Water Main Replacement
- “A Parish Councillor”
- Future Development in the Parish
- Questions and Discussions

The background of the slide features a stylized, light green map of a parish, possibly representing a coastal area with several inlets. A thick, dark blue horizontal bar with rounded ends is positioned across the upper portion of the map. The title text is centered over the map.

PARISH COUNCIL REPORT

COUNCILLOR RICHARD POWELL

PLANNING

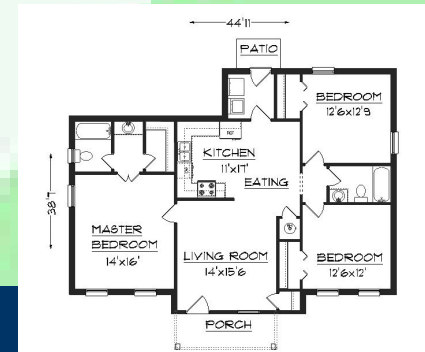

- Wem Rural receives a relatively high number of applications per year (in the top 20 for Shropshire and more than Wem Town)
- Future housing needs for our Parish



HIGHWAYS

- Poor state of roads and Parish Council actions
- Measures taken to improve road safety in our villages



COMMUNICATION

- Rural Review Newsletter
- New notice boards
- New Facebook page and Website
- The Parish Council's role as facilitator between residents, local businesses and Shropshire Council



AND FINALLY....

- THANK YOU



Wem Rural Community Plan

PARISH PLAN UPDATE

COUNCILLOR JON MURGATROYD

Website at www.wemrural.org



So far.....

- **Work on the creation of the 'Parish Plan' started in May 2010.**
- **In June 2010 a committee was formed comprising 2 Parish Councillors and 8 Parishioners.**
- **Between Sept 10 and Jan 11 consultation was carried out at a number of events within the Parish. The information collected was used when compiling the three questionnaires that would be used to gather Parishioner feedback on a wide range of local issues.**
- **The questionnaire's were circulated:**
 - The children's survey in May 11, as an on-line survey, via the local school network;
 - The Adult's Survey in May 11, both paper based and on-line, delivered and promoted door to door;
 - The Business survey in Feb 12, as an on-line survey, promoted via letter to all businesses.
- **Between Sept 11 and Feb 12 the results data has been compiled and analysed.**
- **In April work began on identifying key actions based on the results.**

To do.....



- **Complete the identification of potential actions and prioritise;**
- **Draft the 'Parish Plan' document;**
- **Circulate the draft to key stakeholders for review and comment;**
- **Publish the final version of the 'Parish Plan' and distribute to the community and partners.**

Timescale – Completion and distribution of the final Parish Plan by end 2012

Feedback highlights - Children's survey

- 247 respondents, 50/50 split male / female, age range 8 to 14
- Generally the children describe the parish in positive terms:
 - Friendly – 61%
 - Pleasant – 48%
 - Safe – 45%
 - Neighbourly – 38%
- 60% feel part of the community although 19% don't!
- In terms of crime the key issues are:
 - Vandalism – 32%
 - Anti Social Behaviour – 28%
 - Drugs – 25%
 - Hate crime / Bullying / Racism – 21%
- Key environmental issues are:
 - Dog fouling – 61%
 - Litter / Fly tipping – 51%

Feedback highlights - Children's survey

- Children would prefer not to see land fill sites, overhead power cables, wind farms or waste incineration in the parish. However they are keen to see more solar panels and mobile phone masts!
- The local countryside is valued as follows:
 - As a place to walk by 71%
 - As a place to cycle by 64%
 - To see and enjoy local wildlife by 60%
- 60% think that it is safe to cycle, walk and ride on the roads in the parish.
- Children access the internet 93% at home, 65% at school and 44% via a mobile phone.
- 35% of children are keen to work locally when they leave school.
- 39% want to live locally when they leave home.

Feedback highlights - Business survey

- 10% response rate from local businesses of which 64% produce a local product or provide a local service.
- 60% buy supplies or services from other local businesses.
- 92% of businesses do not forecast any growth in their workforce numbers over the next 12mths.
- Respondents viewed that the key measures needed to keep business, or attract new business, in the parish are:
 - Good internet / broadband – 92%
 - Financial support incentives – 88%
 - Discounted business rates – 76%
 - Improved road infrastructure – 64%
 - Advice on planning matters – 60%

Feedback highlights - Business survey



- 68% of respondents believe that poor broadband supply and mobile phone coverage are restricting their business.
- 68% believe burglary and 64% theft are the key security issues in the area;
- Businesses (68%) are keen to see an increased police presence to help reduce the impact of crime on their businesses;
- Keen interest in the creation and promotion of a 'Local Business Register'.

Feedback highlights - Adult's survey

- 335 respondents which equates to 27.3% of parishes adult population.
- 59% of respondents feel 'part of the community and view the parish positively':
 - Pleasant – 72%
 - Attractive – 59%
 - Clean and friendly – 56%
 - Neighbourly – 51%
- 31% feel traffic in the area is dangerous (69% speeding / 64% heavy vehicles).
- Road maintenance levels are believed to be very poor and parishioners want to see this area addressing urgently.
- Key environmental issues (in order of severity) are:
 - Litter / Fly tipping
 - Damage to grass verges and pavements
 - Overgrown hedges / trees / verges
 - Dog fouling
- 26% of respondents are interested in installing Solar panels. 16% Rain Water Harvesting and / or Ground Source Heat Pumps.

Feedback highlights - Adult's survey

- The public footpath network is used by 48% and valued, although 26% feel that improvements are needed to the signage and maintenance of footpaths.
- In terms of future planning the majority of respondents wish to restrict:
 - The siting of Mobile homes;
 - Industrial scale farms;
 - Large or supersized businesses. (Warehousing, Manufacturing etc)
- However, Eco housing, Barn conversions / building renovations and community facilities are seen positively.
- 64% of respondents own a motor vehicle but 28% would use public transport if services were more frequent and accesable.
- 54% have or do use the services of businesses on the Industrial estate.
- 48% believe the area should be promoted better in tourist information leaflets and promotions.
- 60% disagree with the introduction of parking charges in Wem.

In summary.....

- Our rural environment is valued and parishioners of all ages are keen to embrace more eco friendly technologies.
- All groups see the provision of a meaningful broadband service as essential for the on going development of the parish.
- Minor crime in the community is a concern, particularly for the young in the Parish.
- Traffic issues, specifically speeding and damage to the road infrastructure, need addressing as soon as possible.
- **But most importantly..the vast majority of parishioners feel positively about the community and the area they live in.**





WEM COMMUNITY DIAMOND JUBILEE CELEBRATIONS

COUNCILLOR PETER BROOMHALL



Diamond Jubilee



- In November 2011 Wem Town Council and Wem Rural Parish decided to organise a celebration for the Queen's Diamond Jubilee.
- In December 2011 a meeting was called, this meeting was attended by over 40 people from within the community.



Diamond Jubilee



- A steering group was then formed.
- The steering group met at Wem Town Hall to discuss dates and decided to hold the celebrations on Saturday 2 June and Sunday 3 June.



Diamond Jubilee



- The event is to be held on Wem Recreation Ground, many ideas have been suggested.
- After numerous meetings the itinerary has been decided.
- Plans to be a wonderful community event.

The Queen's DIAMOND JUBILEE

SATURDAY 2nd June

| | | |
|----------|---|--|
| by 10.30 | Town Hall | Cake and Make-a-Crown Competition entries delivered |
| 11am | Town Square | OPENING CEREMONY |
| 12 noon | Wem Town | Vintage Car/Agricultural Vehicle Parade through Wem ending at Edinburgh House |
| 12.30pm | Wem Recreation Ground | Picnic in the Park WEAR SOMETHING RED, WHITE OR BLUE (bring your own rugs and picnics - there will be stalls selling drinks, cakes, ice creams, sweets, etc.) Entertainment/musical performances on stages Stalls, Fair rides, Coconut Shy, Hook-a-duck, Face Painting, Balloon Race, Stocks, Go-carts, Ponies, Children's Games and Races |
| 2-3pm |  | HOG ROAST |
| 3.15pm | | Fancy Dress judging (Theme KINGS & QUEENS) |
| 4pm | | Prize giving |
| 6pm | | Tug of War |
| 9pm | | Evening entertainment on stages - live music |
| 10pm | | Grand Finale (lighting of Fire Beacon) Fireworks |

SUNDAY 3rd June

| | | |
|---------|------------------|---|
| 11.30am | Wem Rec. | United Service of Celebration |
| 12.30pm | Millennium Green | Stalls and Memorabilia Display |
| 1pm | Town Hall | 3 hour screening of the Pageant (all welcome - no need to book) |

NB Times are a guideline only and some may vary



**Celebrate with the
Wem Community**



The Queen's DIAMOND JUBILEE



COMPETITIONS

BEST ROYAL CAKE

1st, 2nd and 3rd prizes in 3 classes
Primary school, Secondary school and Adult
Entries to the Town Hall by 10.30am on Saturday 3rd June

FANCY DRESS

on a theme of Kings and Queens

1st, 2nd and 3rd prizes in 4 classes
Under 5's, 5-10 years, 10-16 years and Adult
To be judged at 3.15pm on Saturday 3rd June
on the Wem Recreation Ground



MAKE A CROWN FIT FOR A KING OR QUEEN

1st, 2nd and 3rd prizes in 3 classes
Primary school, Secondary school and Adult
Entries to the Town Hall by 10.30am on Saturday 3rd June

TUG of WAR

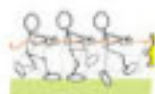

Teams of 8 (mixed, men's and women's)
1st and 2nd places
To take place approximately 6pm on Wem Rec.



CHILDREN'S RACES

just come along to the Wem Rec.
and join in on Saturday 3rd June at approximately 2pm

(full competition rules overleaf)



**Celebrate with the
Wem Community**

